

## Aarhus School of Architecture // Design School Kolding // Royal Danish Academy

### Enriched Simplicity; Japanese influx on Danish Architecture 1950-2020

Julebæk, Victor Boye

*Publication date:*  
2021

*Document License:*  
Unspecified

[Link to publication](#)

*Citation for published version (APA):*

Julebæk, V. B. (2021). Enriched Simplicity; Japanese influx on Danish Architecture 1950-2020: The Royal Danish Embassy in Japan Tokyo. Contribution to exhibition

#### General rights

Copyright and moral rights for the publications made accessible in the public portal are retained by the authors and/or other copyright owners and it is a condition of accessing publications that users recognise and abide by the legal requirements associated with these rights.

- Users may download and print one copy of any publication from the public portal for the purpose of private study or research.
- You may not further distribute the material or use it for any profit-making activity or commercial gain
- You may freely distribute the URL identifying the publication in the public portal ?

#### Take down policy

If you believe that this document breaches copyright please contact us providing details, and we will remove access to the work immediately and investigate your claim.

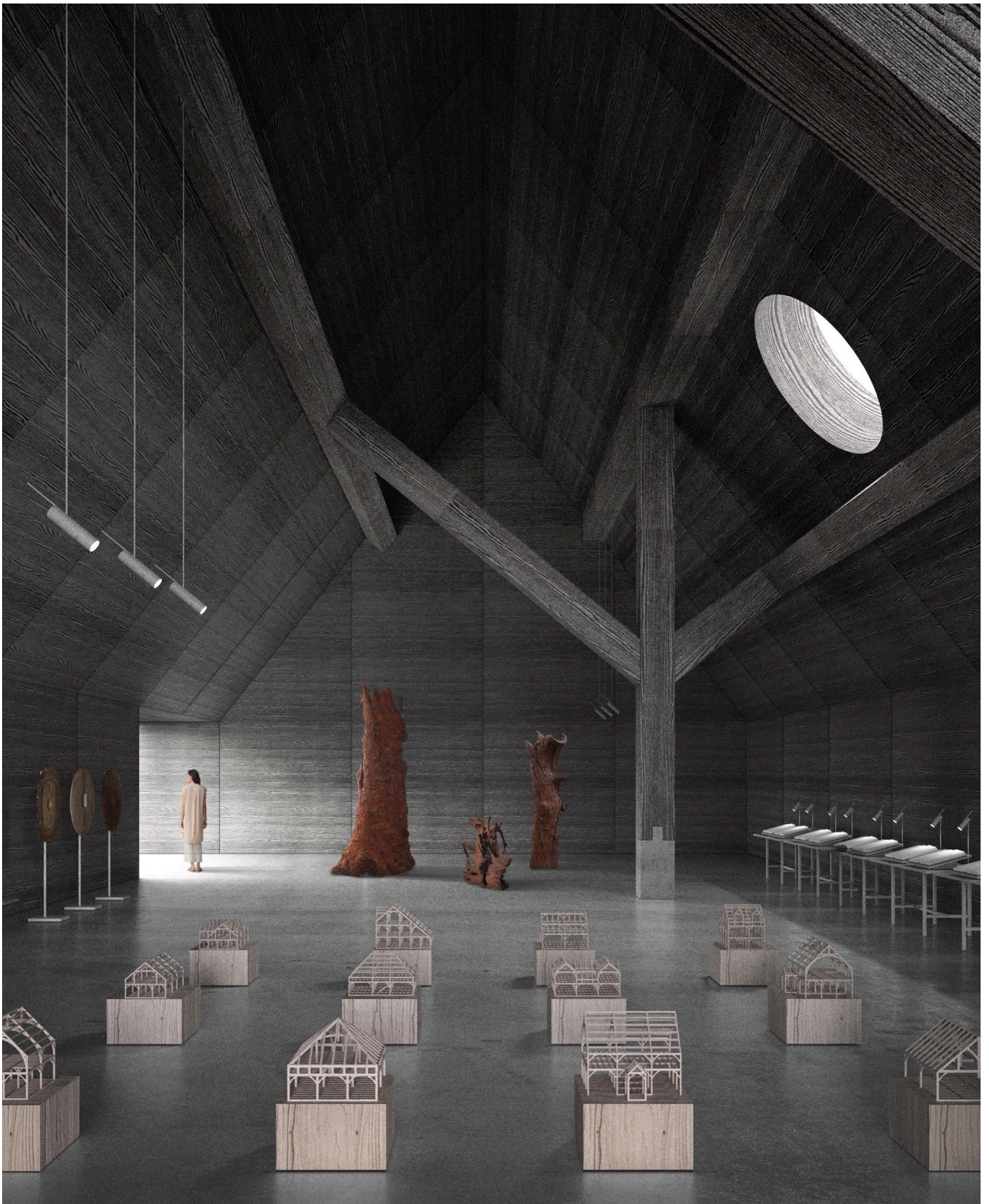

**Competition Project Exhibition Building  
Victor Boye Julebæk 2018**